

GNL-1430xx (1.4X3.0mm TOP TYPE)

ABSOLUTE MAXIMUM RATING:(Ta=25°C)

Parameter	Symbol	Max	Unit
DC Forward Current	I_F	30	mA
Reverse Voltage	V_R	6	V
Reverse Current (Vr=5V)	I_R	10	μ A
Peak Forward Current ,tw ,=1 msec Duty ,=1/20	I_{FP}	100	mA
Operation Temperature	Topr	-20-80	°C
Storage Temperature	Tstg	-40-80	°C
Solder Dip (10seconds,1.6mm from body) Temperature		260	°C

Package Dimensions

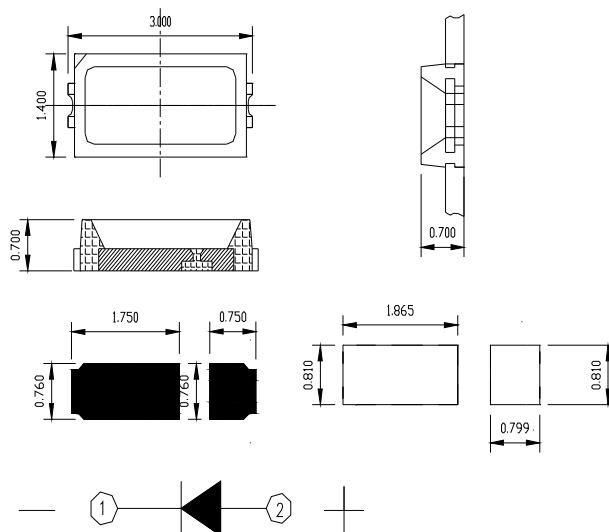

- All dimensions are in millimeters
- Tolerance of + or - 0.25mm 0.010 in. (unless otherwise noted)

Part Number	EMITTED COLOR		Lens Color	Peak Wavelength (nm)	Vf (v) Typ	IV (If=30mA)		View Angle 2 θ 1/2
						Min.	Typ.	
GNL-1430UWC	INGaN	White	Yellow phosphor	5500K-7000K	3.2	9	10	120°
GNL-1430UWC-S	INGaN	Natural white	Yellow phosphor	3700K-4400K	3.2	9	10	120°
GNL-1430UWC-Y	INGaN	Warm White	Yellow phosphor	2800K-3200K	3.2	9	10	120°