

## GNM-19881Ax-Bx (SINGLE COLOR MATRIX DISPLAY)

GNM-19881 Series

GNM-19881Ax

GNM-19881Bx

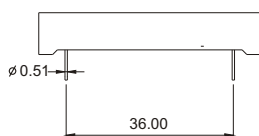
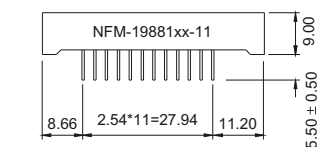
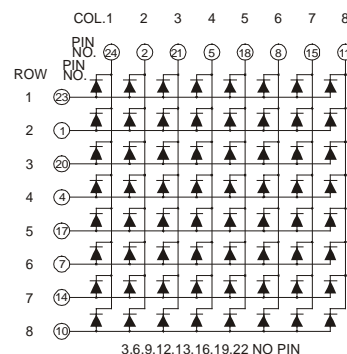
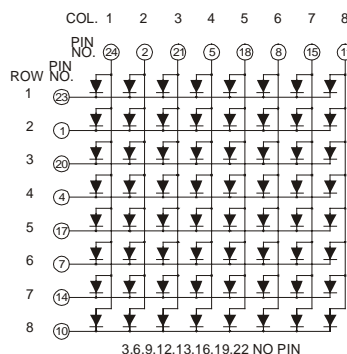
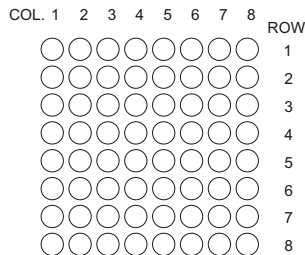
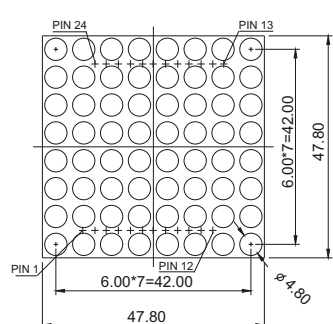

### Features:

- \* 4.8 Dot Size
- \* 8x8 Array with x-y select
- \* Low power, High brightness

Part Number	EMITTED COLOR		Common Cathode or Common Anode	Peak Wavelength (nm)	Vf (v) Typ	If (mA)	Intensity Per Dot (mcd)	
							Min.	Typ.
GNM-19881AE	GaAsP/GaP	Hi.effi Red	Common Cathode	635	2.0	20	9	12
GNM-19881AG	GaP	Green		565	2.1	20	8	11
GNM-19881AY	GaAsP/GaP	Yellow		585	2.0	20	9	12
GNM-19881AS	GaAlAs	Super Red		660	1.8	20	10	13
GNM-19881AD	GaAlAs	Ultra Red		660	1.8	20	25	30
GNM-19881AUE	AlGaInP	Ultra Red		625	2.0	20	30	35
GNM-19881AUY	AlGaInP	Ultra Yellow		590	2.0	20	30	35
GNM-19881BE	GaAsP/GaP	Hi.effi Red	Common Anode	635	2.0	20	9	12
GNM-19881BG	GaP	Green		565	2.1	20	8	11
GNM-19881BY	GaAsP/GaP	Yellow		585	2.0	20	9	12
GNM-19881BS	GaAlAs	Super Red		660	1.8	20	10	13
GNM-19881BD	GaAlAs	Ultra Red		660	1.8	20	25	30
GNM-19881BUE	AlGaInP	Ultra Red		625	2.0	20	30	35
GNM-19881BUY	AlGaInP	Ultra Yellow		590	2.0	20	30	35